

RECORD OF SURVEY
A PORTION OF THE SW 1/4 OF THE NE 1/4 OF SEC. 4,
TOWNSHIP 19 NORTH, RANGE 15 EAST, W.M.,
KITTITAS COUNTY, WASHINGTON

EXISTING LEGAL DESCRIPTIONS:

LEGAL DESCRIPTION PER CHICAGO TITLE COMPANY GUARANTEE NO. 72156-46050828

PARCEL 2A OF THAT CERTAIN SURVEY AS RECORDED OCTOBER 27, 2011, IN BOOK 37 OF SURVEYS, PAGE 201, UNDER AUDITOR'S FILE NO. 201110270036, RECORDS OF KITTITAS COUNTY, WASHINGTON, BEING A PORTION OF THE SOUTHWEST QUARTER OF THE NORTHEAST QUARTER OF SECTION 4, TOWNSHIP 19 NORTH, RANGE 15 EAST, W.M.

LEGAL DESCRIPTION PER CHICAGO TITLE COMPANY GUARANTEE NO. 72156-46050631

PARCEL 1 OF THAT CERTAIN SURVEY AS RECORDED APRIL 27, 2010, IN BOOK 37 OF SURVEYS, PAGE 11, UNDER AUDITOR'S FILE NO. 201004270027, RECORDS OF KITTITAS COUNTY, WASHINGTON; BEING A PORTION OF THE SOUTHWEST QUARTER OF THE NORTHEAST QUARTER OF SECTION 4, TOWNSHIP 19 NORTH, RANGE 15 EAST, W.M., IN THE COUNTY OF KITTITAS, STATE OF WASHINGTON.

REVISED LEGAL DESCRIPTIONS:

PARCEL 2A1

PARCEL 2A OF THAT CERTAIN SURVEY AS RECORDED OCTOBER 27, 2011, IN BOOK 37 OF SURVEYS, PAGE 201, UNDER AUDITOR'S FILE NO. 201110270036, RECORDS OF KITTITAS COUNTY, WASHINGTON, BEING A PORTION OF THE SOUTHWEST QUARTER OF THE NORTHEAST QUARTER OF SECTION 4, TOWNSHIP 19 NORTH, RANGE 15 EAST, W.M., IN THE COUNTY OF KITTITAS, STATE OF WASHINGTON.

EXCEPT THAT PORTION OF SAID PARCEL 2A WHICH IS BOUNDED BY A LINE DESCRIBED AS FOLLOWS:

COMMENCING AT THE WESTERN MOST CORNER OF SAID PARCEL 2A, WHICH IS ALSO THE TRUE POINT OF BEGINNING;

THENCE NORTH 66°03'36" EAST ALONG THE NORTHERLY BOUNDARY LINE OF SAID PARCEL 2A, 173.91 FEET;

THENCE CONTINUING ALONG SAID NORTHERLY BOUNDARY LINE, NORTH 38°33'22" EAST, 248.80 FEET;

THENCE SOUTH 02°51'46" WEST, 530.76 FEET TO A POINT ON THE WESTERLY BOUNDARY LINE OF SAID PARCEL 2A;

THENCE NORTH 63°41'46" WEST ALONG SAID WESTERLY BOUNDARY LINE, 264.56 FEET;

THENCE CONTINUING ALONG SAID WESTERLY BOUNDARY LINE, NORTH 18°49'11" WEST, 156.07 FEET MORE OF LESS TO THE TRUE POINT OF BEGINNING.

PARCEL 1A

PARCEL 1 OF THAT CERTAIN SURVEY AS RECORDED APRIL 27, 2010, IN BOOK 37 OF SURVEYS, PAGE 11, UNDER AUDITOR'S FILE NO. 201004270027, RECORDS OF KITTITAS COUNTY, WASHINGTON; BEING A PORTION OF THE SOUTHWEST QUARTER OF THE NORTHEAST QUARTER OF SECTION 4, TOWNSHIP 19 NORTH, RANGE 15 EAST, W.M., IN THE COUNTY OF KITTITAS, STATE OF WASHINGTON.

AND

THAT PORTION OF PARCEL 2A OF THAT CERTAIN SURVEY AS RECORDED OCTOBER 27, 2011, IN BOOK 37 OF SURVEYS, PAGE 201, UNDER AUDITOR'S FILE NO. 201110270036, RECORDS OF KITTITAS COUNTY, WASHINGTON, BEING A PORTION OF THE SOUTHWEST QUARTER OF THE NORTHEAST QUARTER OF SECTION 4, TOWNSHIP 19 NORTH, RANGE 15 EAST, W.M., IN THE COUNTY OF KITTITAS, STATE OF WASHINGTON, WHICH IS BOUNDED BY A LINE DESCRIBED AS FOLLOWS:

COMMENCING AT THE WESTERN MOST CORNER OF SAID PARCEL 2A, WHICH IS ALSO THE TRUE POINT OF BEGINNING;

THENCE NORTH 66°03'36" EAST ALONG THE NORTHERLY BOUNDARY LINE OF SAID PARCEL 2A, 173.91 FEET;

THENCE CONTINUING ALONG SAID NORTHERLY BOUNDARY LINE, NORTH 38°33'22" EAST, 248.80 FEET;

THENCE SOUTH 02°51'46" WEST, 530.76 FEET TO A POINT ON THE WESTERLY BOUNDARY LINE OF SAID PARCEL 2A;

THENCE NORTH 63°41'46" WEST ALONG SAID WESTERLY BOUNDARY LINE, 264.56 FEET;

THENCE CONTINUING ALONG SAID WESTERLY BOUNDARY LINE, NORTH 18°49'11" WEST, 156.07 FEET MORE OF LESS TO THE TRUE POINT OF BEGINNING.

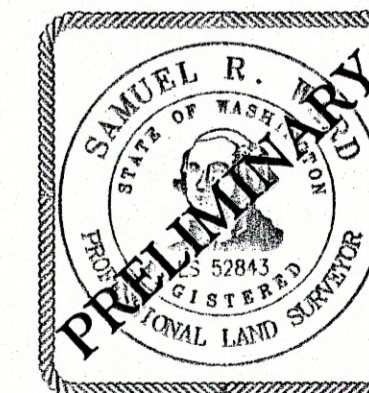

<p>AUDITOR'S CERTIFICATE _____</p> <p>FILED FOR RECORD THIS ____ DAY OF ____ 20__ AT ____ M.</p> <p>IN BOOK ____ OF _____ AT PAGE ____ AT THE REQUEST OF</p> <p style="text-align: center;"><u>SAMUEL R. WARD</u> SURVEYOR'S NAME</p> <p style="text-align: center;"><u>JERALD V. PETTIT</u> County Auditor</p> <p style="text-align: center;">_____ Deputy County Auditor</p>	<p style="text-align: center;">SURVEYOR'S CERTIFICATE</p> <p>THIS MAP CORRECTLY REPRESENTS A SURVEY MADE BY ME OR UNDER MY DIRECTION IN CONFORMANCE WITH THE REQUIREMENTS OF THE SURVEY RECORDING ACT AT THE REQUEST OF <u>PETER KOHL</u></p> <p>IN <u>AUGUST 20 17</u></p> <p style="text-align: center;"><u>SAMUEL R. WARD</u> DATE CERTIFICATE NO. <u>52843</u></p>	<p>Western Washington Division 165 NE Juniper Street, Suite 201 • Issaquah, WA 98027 • Phone: (425) 392-0250 • Fax: (425) 391-3055</p> <p>Eastern Washington Division 407 Swiftwater Blvd. • Cle Elum, WA 98922 • Phone: (509) 674-7433 • Fax: (509) 674-7419</p>	<p style="text-align: center;">BOUNDARY LINE ADJUSTMENT</p> <p style="text-align: center;">PREPARED FOR PETER KOHL A PORTION OF THE SW 1/4 OF THE NE 1/4 OF SECTION 4, TOWNSHIP 19 NORTH, RANGE 15 EAST, W.M.</p> <p style="text-align: center;">KITTITAS COUNTY WASHINGTON</p> <table border="1" style="width: 100%; border-collapse: collapse;"> <tr> <td style="width: 33%;">DWN BY G. WEISER</td> <td style="width: 33%;">DATE 08/2017</td> <td style="width: 33%;">JOB NO. 046901</td> </tr> <tr> <td>CHKD BY S. WARD</td> <td>SCALE N/A</td> <td>SHEET 2 OF 2</td> </tr> </table>	DWN BY G. WEISER	DATE 08/2017	JOB NO. 046901	CHKD BY S. WARD	SCALE N/A	SHEET 2 OF 2
DWN BY G. WEISER	DATE 08/2017	JOB NO. 046901							
CHKD BY S. WARD	SCALE N/A	SHEET 2 OF 2							